

STERLING ROAD - ROUTE 62
BUS PICKUP / DROP OFF

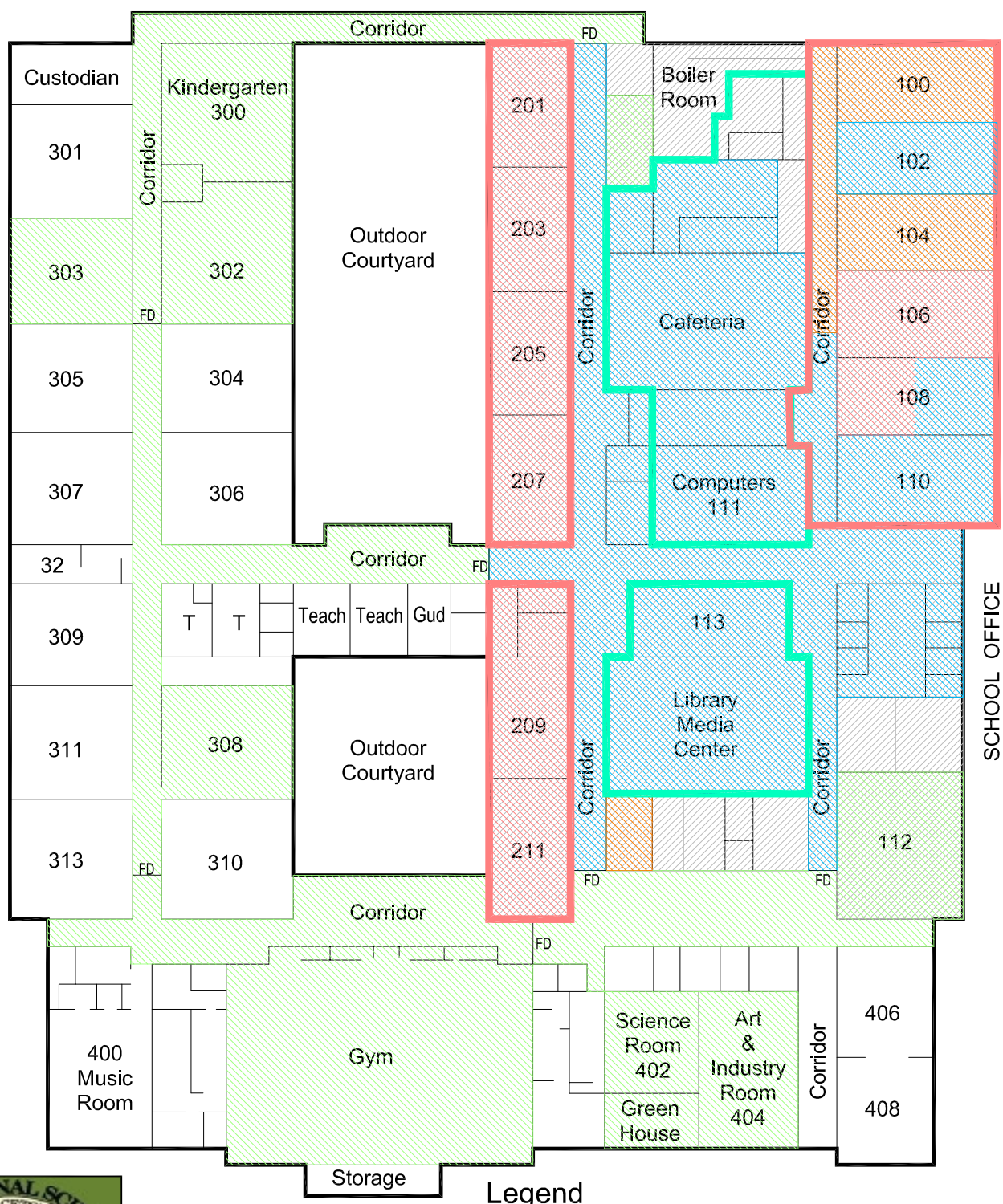

PLAYGROUND

STUDENT PICKUP / DROP OFF



Legend

- >300 ng/m3 in Air
- <300, >200 ng/m3 in Air
- <200, >100 ng/m3 in Air
- <100 ng/m3 in Air
- Building Constructed 1962
- Un-hatched sections were constructed in 1991
- Access Restricted Until Cleaned
- Access Restricted



997 Milbury Street - Unit G • Worcester, MA 01607
Phone: 508-756-0151 Fax: 508-757-7063
ecsconsult.com

PROJECT: Thomas Prince School
170 Sterling Road - Route 62
Princeton, Massachusetts

TITLE: Air Concentration Ranges

COMPUTER CADFILE : 216450e.dwg			
DRAWN BY:	DESIGNED BY:	CHECKED BY:	APPROVED BY:
RAS	SPF/CK	SPF/CK	SPF/CK
SCALE:	DATE:	JOB NO.:	FIGURE NO.:
NTS	8/25/11	216450	